

# DIVITHEMECENTER LAYOUT INSTALLATION GUIDE

**Visit :** <https://divithemecenter.com/general-layout-installation-guide-latest>

**Author:** Divi Theme Center

**Imagesource:** <https://pixabay.com/>, <http://www.stockunlimited.com/>

## Minimum requirements:

**WordPress Version** : 5.2.0  
**PHP Version** : 7.2.x+  
**MySQL Version** : 5.7.x+

<https://wordpress.org/about/requirements/>

Zip upload installation method (make sure uploads up to 2MB are allowed for your hosting):

## How To Import Divi Layout:-

Steps for importing layout:

1. Open WordPress Dashboard -> Activate Divi Parent Theme->Start By Downloading Zip File and [Xml File](#)
2. Unzip files and you will find one copy of each ie XML File(media.xml, post.xml, project.xml), Layout JSON File, and CSS File.
3. Import post xml / media xml file only in our case under Tools -> Import ->WordPress Import
4. Import Layout (.json) file under Divi -> Divi Library -> Import & Export Button

### Further Explanation :-

– For ‘ Provided Product Zip ‘ we have created ‘JSON ‘ file for each version that you can import via Page / Library both.

That is you can find 2 folders in Zip folder as A.Library JSON B. Page JSON.

In Each folder you will find JSON files for each version. You need import one version at a time to make ie for example if you want to load ‘ Example V1 ’ you need import ‘ Example V1 Library.JSON ‘ as mentioned in the step 4.

- Similarly you can import all version’s individually either via Page or Library

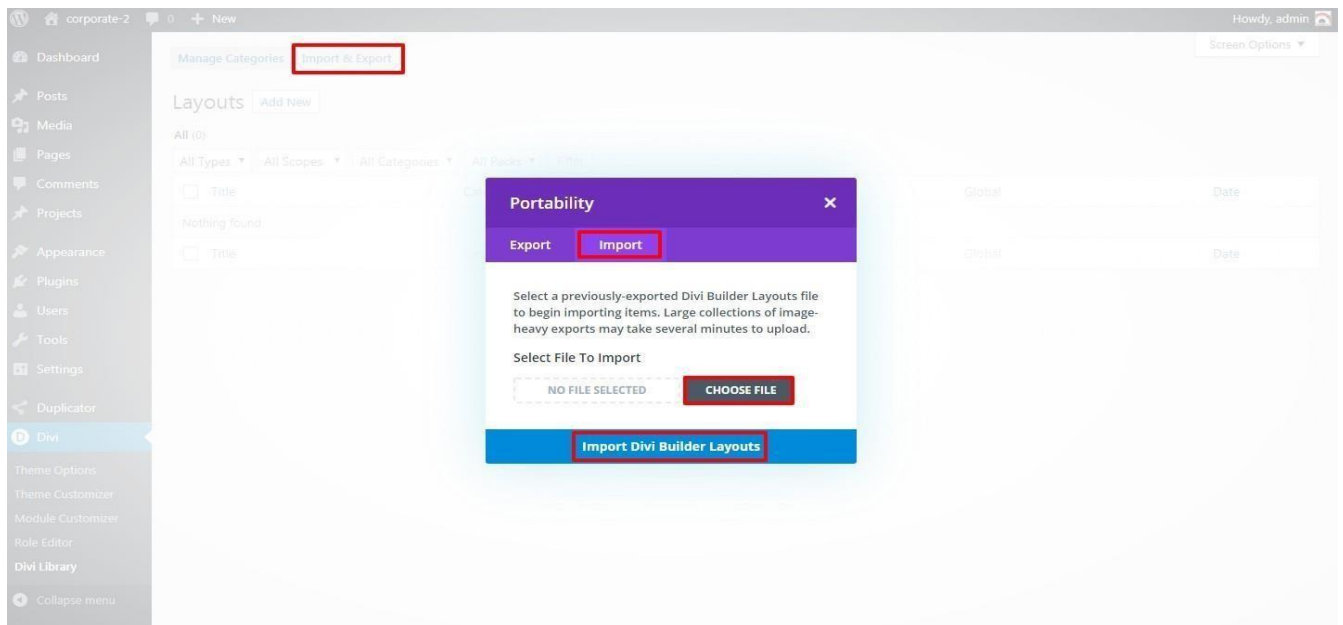

5. After importing JSON files you will see a sbelow:

<input type="checkbox"/> Title	Categories	Type	Global	Date
Nothing found ← <i>Divi Layout - your layout name will appear here</i>				
<input type="checkbox"/> Title	Categories	Type	Global	Date

## 6. Add New Page and Click on “Load Layout”

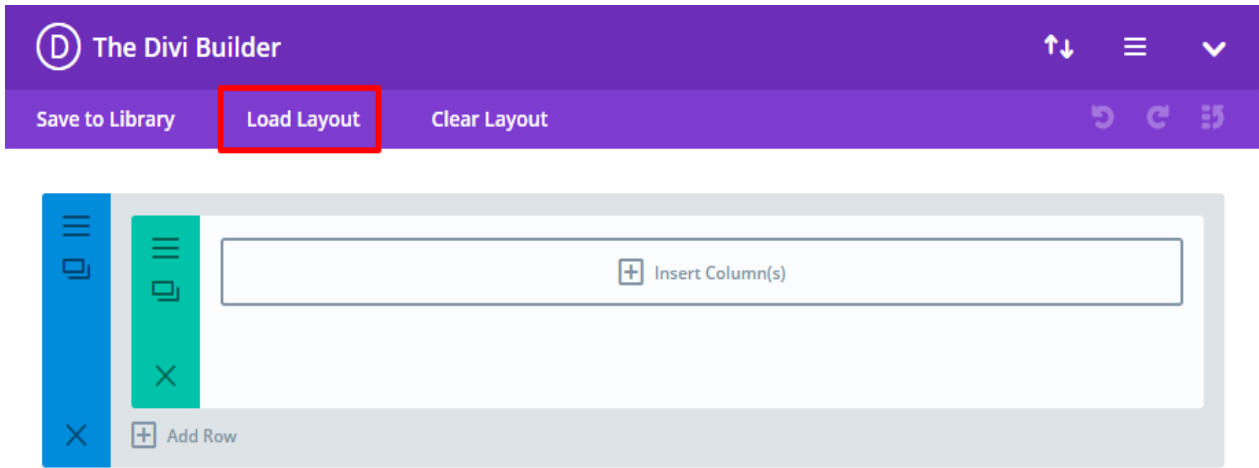

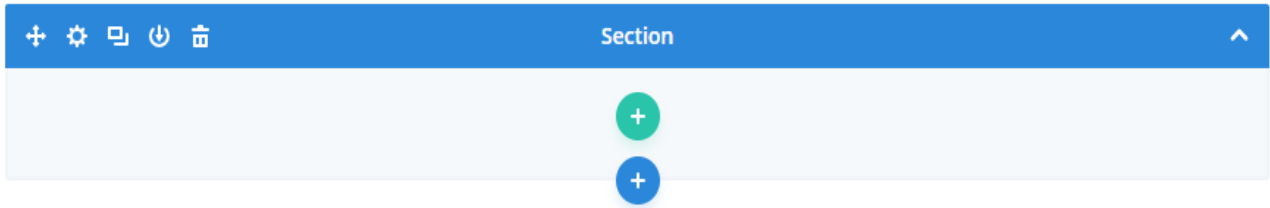
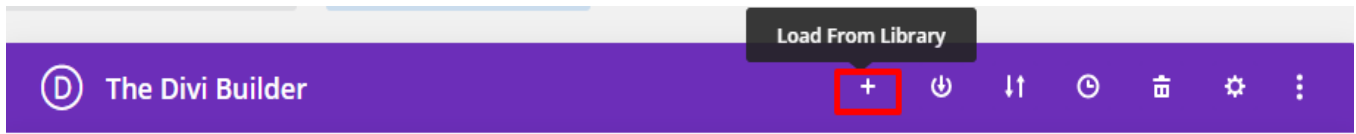

## 7. Select layout

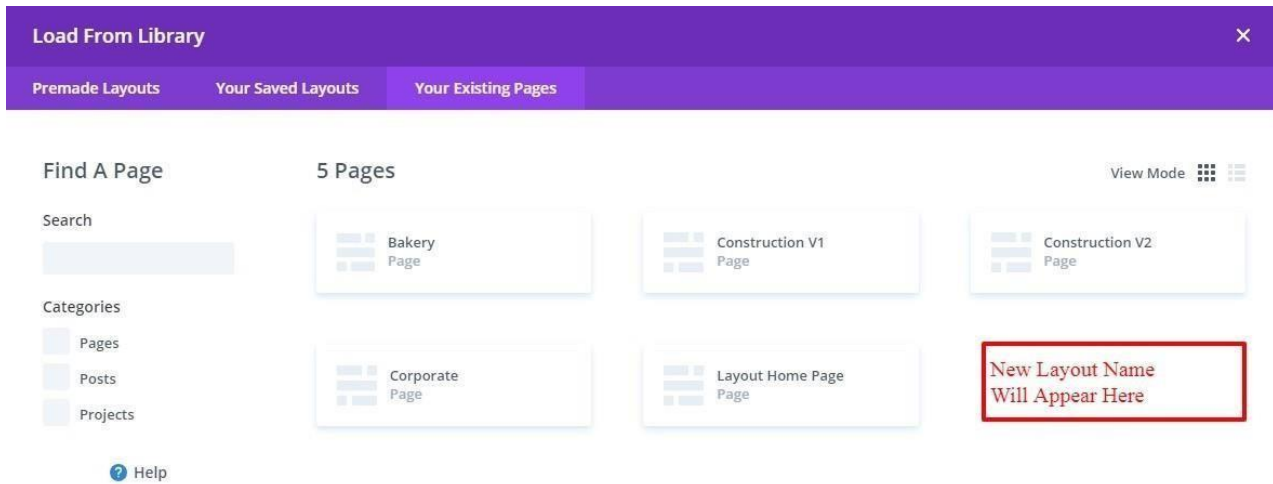

8. After selecting the layout ' Publish Page ' and see at the front end and go to step9.

OR

If you face any issue during loading then you can upload JSON " ViaPage " as per screenshot below

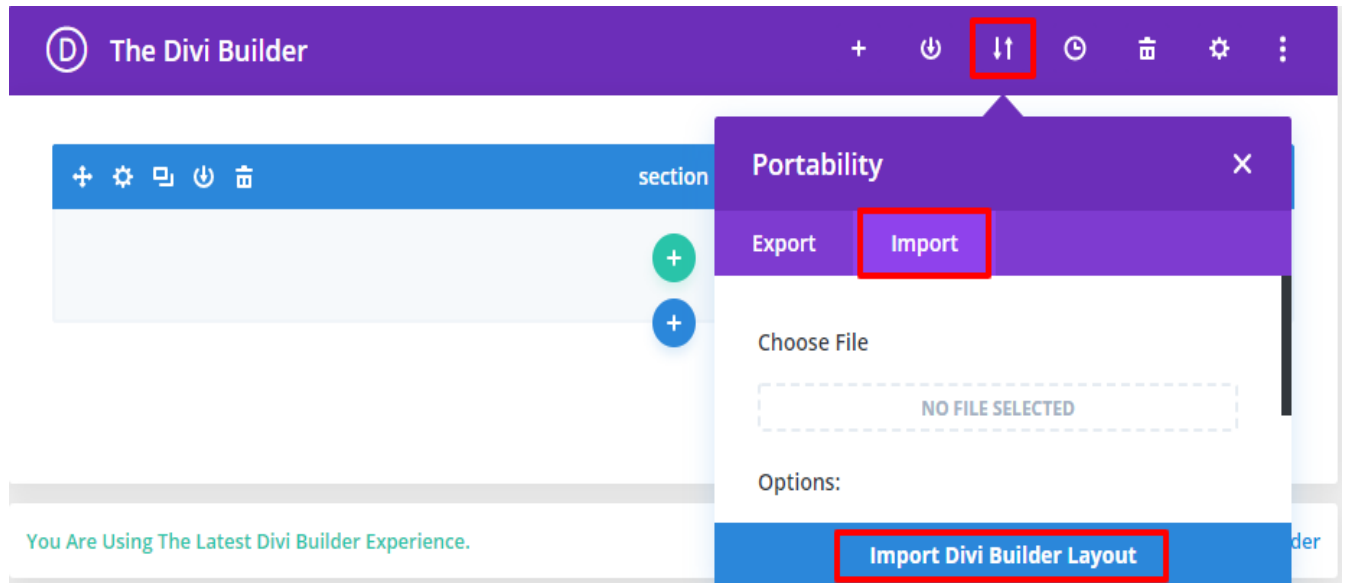

9. How To Add 'CSS' code ? (This is only applicable if 'CSS' file is provided in the product Zip else skip this step and is not needed):

Add ".css" file in your child theme and Enqueue your style using wordpress function `wp_enqueue_style`

OR

Copy CSS from file and "PASTE" under Divi -> Theme Option -> General -> Custom CSS

10. How To Add JS Code? (This is only applicable if 'JS' file is provided in the product Zip else skip this step and is not needed):

Add js Code -> Go To "Divi Theme Option" & Click on "Integration" Tab -> In Code Section -> Add JS Code In `<>head<>` Tag as shown in the screenshot ie `blog-layout.js` Code available in the product Zip File

General Navigation Builder Layout Ads SEO Integration Updates ↑ ↓ ↻

Code Integration

Enable header code  ENABLED

Enable body code  ENABLED

Enable single top code  ENABLED

Enable single bottom code  ENABLED

Add code to the < head > of your blog

Added copy to paste js code

## How To Import Logo / Theme Customizer JSON?

This is available as separate 'JSON' file as 'Logo.Json or Theme Customizer.json' file and do not get confused it with 'Page / Style Version' Json files.

To Import Logo / Theme Customizer setting Go To Divi -> Theme Option -> Import JSON by clicking 'Arrow' at the top and Click on Import.

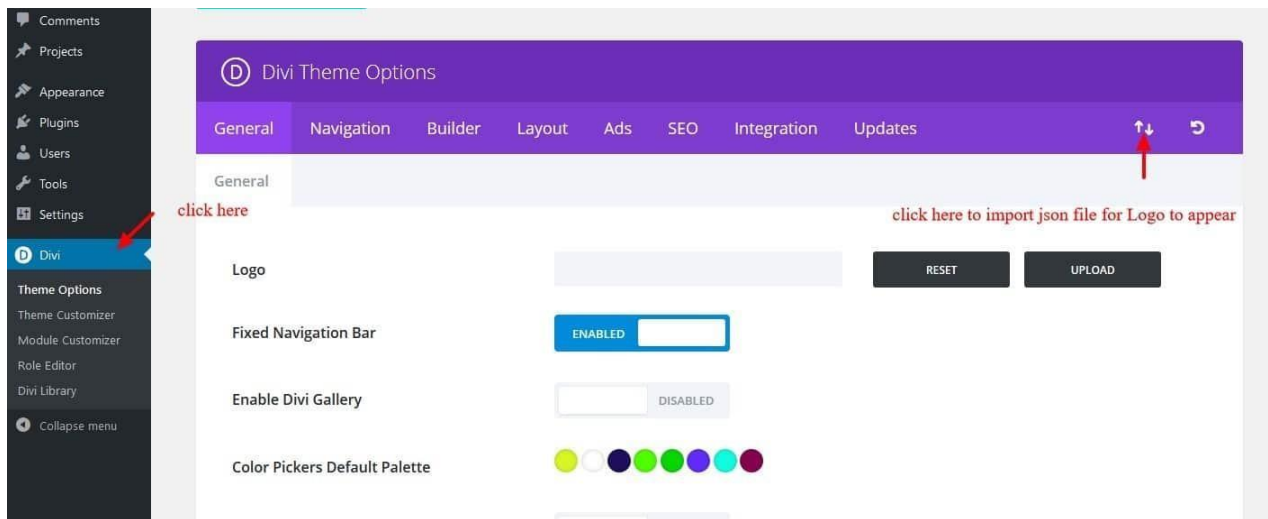

## How To Set HomePage Under Menu Option & Set Menu Structure In Divi ?

If you see 'Posts / Layouts' appearing as 'HomePage / Navigation' that you don't need, than you might need to do the required setting in the 'Menu' as per the steps mentioned below:

### A. How To Set HomePage Under Menu Option :

#### Step 1:

Go To -> Appearance – Customize -> Homepage Setting

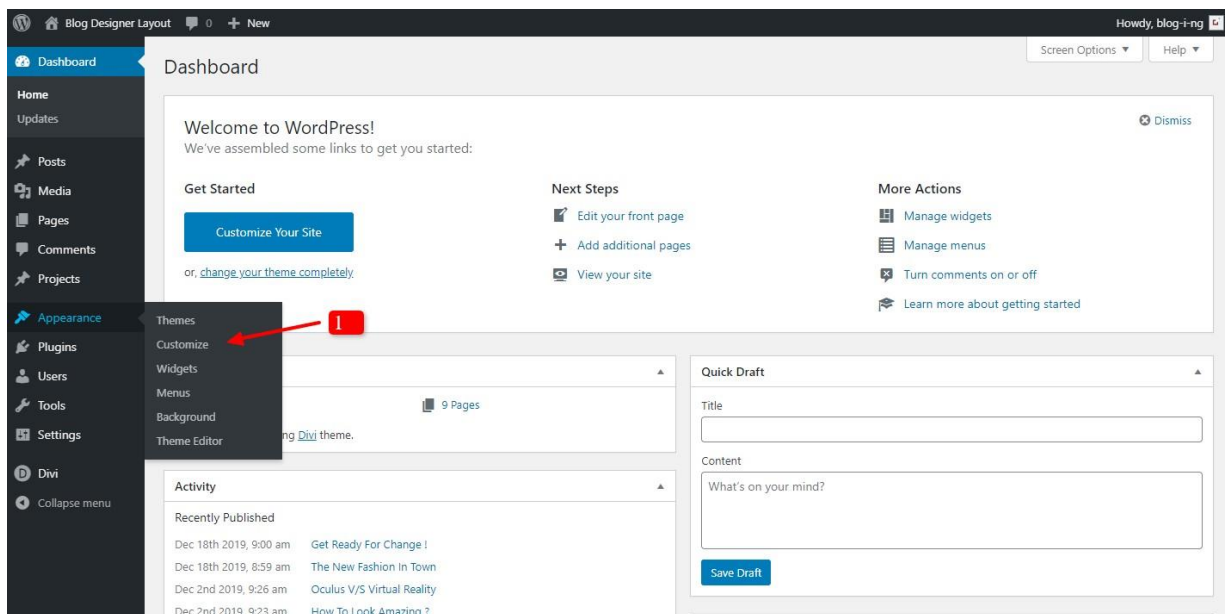

Published

Blog Designer Layout

Active theme Divi [Change](#)

General Settings >

Header & Navigation >

Footer >

Buttons >

Blog >

Mobile Styles >

Color Schemes >

Menus >

Widgets >

**Homepage Settings >**

Additional CSS >

Hide Controls

LOREM IPSUM

Full Width Style | Timeline Style | Grid Style | Slider Style

**The New Fashion In Town**  
by blog-i-ng | Dec 18, 2019 | Lifestyle  
Lorem ipsum dolor sit amet, consectetur adipiscing elit, sed do eiusmod tempor incididunt ut labore et dolore magna aliqua. Ut enim ad minim veniam, quis...  
[Read More](#)

**Best Street Style In Paris**  
by blog-i-ng | Dec 2, 2019 | Fashion

## Step 2 :

Select Static Page -> Select Page That You Need Set As HomePage (like in example it is photo click) -> Publish -> Check Front-End For Changes

Published

Customizing Homepage Settings

You can choose what's displayed on the homepage of your site. It can be posts in reverse chronological order (classic blog), or a fixed/static page. To set a static homepage, you first need to create two Pages. One will become the homepage, and the other will be where your posts are displayed.

YOUR HOMEPAGE DISPLAYS

Your latest posts

A static page

HOMEPAGE

Photo Click

[+ Add New Page](#)

POSTS PAGE

— Select —

[+ Add New Page](#)

Hide Controls

LOREM IPSUM

Full Width Style | Timeline Style | Grid Style | Slider Style

**The New Fashion In Town**  
by blog-i-ng | Dec 18, 2019 | Lifestyle  
Lorem ipsum dolor sit amet, consectetur adipiscing elit, sed do eiusmod tempor incididunt ut labore et dolore magna aliqua. Ut enim ad minim veniam, quis...  
[Read More](#)

**Best Street Style In Paris**  
by blog-i-ng | Dec 2, 2019 | Fashion



## B. How to set Menu Structure?

Step1:

Go To Appearance -> Menu -> Select Menu Name (usually as 'Main Menu') -> Create Menu

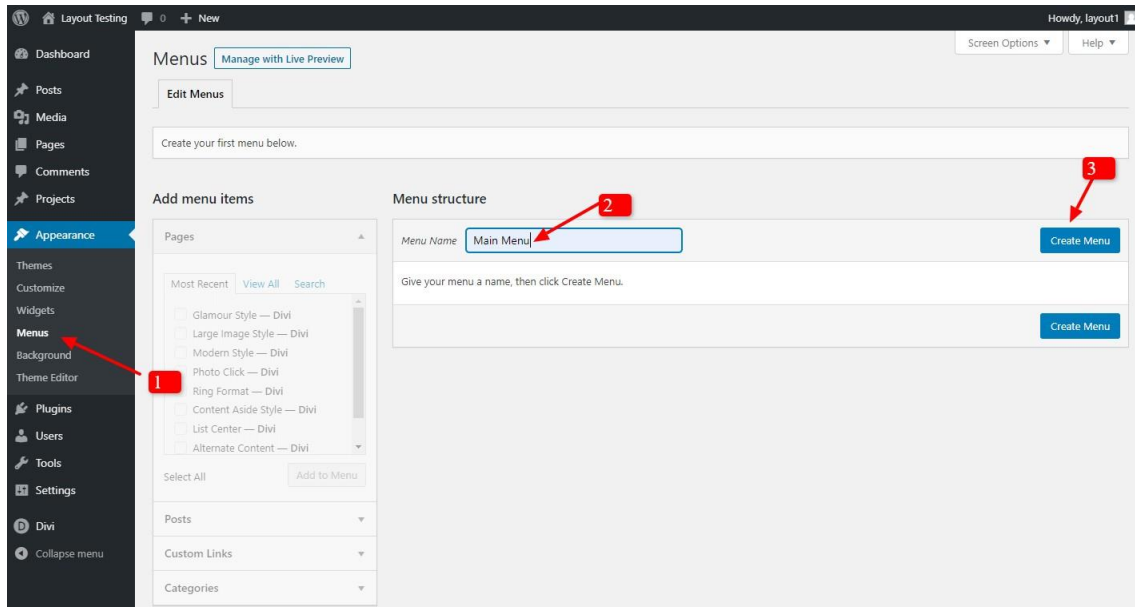

Step2:

Select All Page You Need Add In Menu

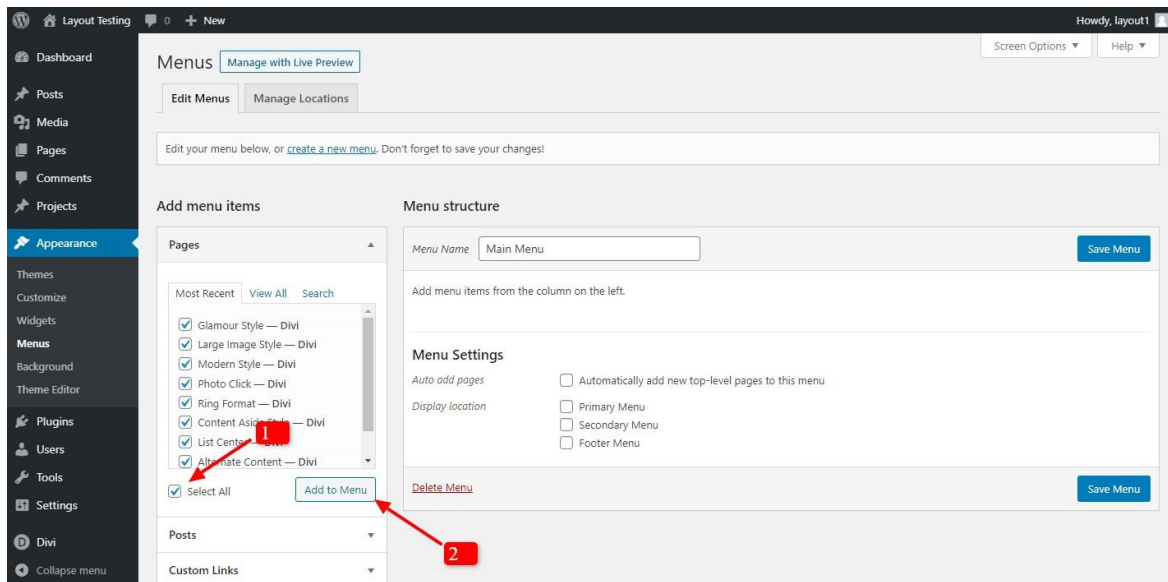

### Step3:

Under Menu setting Tick Mark 2 Check Boxes

-> Automatically add new top-level pages to this menu

-> Select Menu Option (Usually It Is ' Primary Menu ')

The screenshot shows the WordPress Admin Dashboard with the 'Appearance' menu selected. The 'Menus' section is active, displaying a list of menu styles and their settings. The 'Menu Settings' section is expanded, showing the following options:

- Auto add pages:**  Automatically add new top-level pages to this menu (labeled 1)
- Display location:**  Primary Menu (labeled 2),  Secondary Menu,  Footer Menu

At the bottom of the 'Menu Settings' section, there is a 'Delete Menu' link and a 'Save Menu' button (labeled 3). The 'Save Menu' button is highlighted in blue.